

Earth and continuity tester

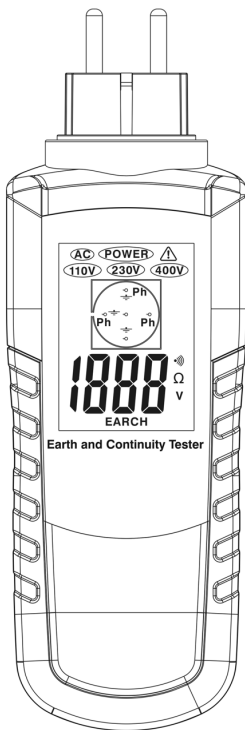

The earth tester enables you to perform the following operations:

- check the resistance of the earth socket
- locate the position of the live pin (right or left), check the earth connection.
- check for 230V (or an abnormal voltage)
- check continuity (earth conductor, main and local equipotential connections)

These test points are required by standard NF C 15-100 and assist in delivering a compliant installation.

To facilitate testing , the tester can be used directly on 2P+E 10/16 A sockets.

In addition, the two-colour backlighting will alert you instantaneously to the condition of your installation.

Blue: OK, Red: fault (earth $>$ 100 Ω , incorrect voltage, etc.)

Controls and Jacks

1. IP2X safety plug for safety probe
2. LCD display (blue/red)
3. Plugs for 2P+T sockets 10/16A
4. Winder, length 7 m
5. IP2X plug
6. Safety probe IP2X
7. Non-slip coating

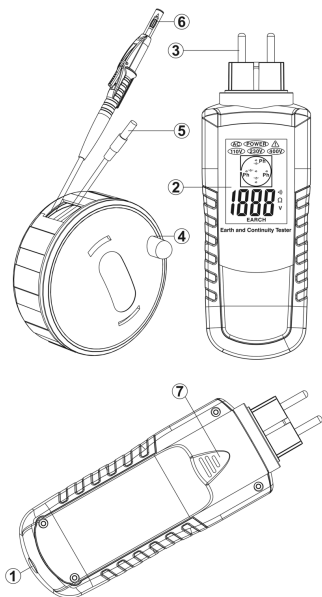

Testing the earth pin

Testing the local earth employs the “ fault loop” principle. It applies to TT (EE) type installations.

After connecting the unit to a 2P+E socket the earth resistance value is displayed.

Standard NF C15-100 requires a value of earth resistance of less than 100Ω.

If this value is obtained, the backlighting is in blue, if the value is above 100Ω, the screen turns red:

fig.1; value OK, Fig.2: value not OK

Your instrument measures values up to 1999Ω. Above that, the display indicates OL (overload = value exceeded), Fig.3: Earth resistance greater than 1999Ω.

Testing the sockets

- Location of the position of the live pin (right or left)
- Earth connection
- Voltage present

A pictogram represents the base of the socket and indicates the position of the live Pin (right or left).

The same pictogram displays the presence of an earth (displayed for any earth < 2000Ω. In addition, a reminder of the voltage is indicated (230V).

If the (400V!) pictogram appears, , check the installation. **400V**

Fig.4: Earth connected, Live on right, 230V.

Fig.5: Earth not connected Live on left, Incorrect voltage.

Continuity test

The continuity of the earth protection conductors and the equipotential connections (main and local) must be tested. In accordance with NF C 15-100, the tester enables you to check that the resistance is less than 2Ω . Firstly, connect the cable on the reel to the body of the unit, then connect your unit to a 2P+E socket. Then, with the retractable test probe, make contact with the parts to be checked. Continuity of the connections is indicated by a continuous audible signal.

Notes:

- 1 – when the unit is in the CONTINUITY mode, the back lighting is switched off (to ensure the measurement current of 200mA specified by NFC 15-100).
- 2 – if there is an abnormal voltage on the earth protection conductors, the unit enters the Err mode and sounds intermittently.

General characteristics

- Principle of measurement by “fault loop” for installations with neutral as per diagram TT
- Earth loop measurement current less than the drop-out threshold of the 30mA circuit breakers
- Measurement of the earth resistance by 3 + 1/2 digit display from 0 to 1999 Ω (resolution 1 Ω , measurement updated every 1.5s)
- Accuracy: +/- (3% + 3digit) for pure resistance (range 0-200 Ω at 23 $^{\circ}\text{C}$ +/- 5 $^{\circ}\text{C}$)
- Operating voltage: 230V(Ph/N) -10/+6%
- Operating frequency: 50/60Hz
- IEC 61010-1 EN 61557-4
- Installation category III
- Class II IP40,IK06
- Operating temperature: -15 $^{\circ}\text{C}$ /+45 $^{\circ}\text{C}$
- Storage temperature: -25 $^{\circ}\text{C}$ /+70 $^{\circ}\text{C}$
- Weight : 340g(unit alone)
- Dimensions of unit: l=72mm L=210mm H=50mm
Two-colour back-lit LCD display

Warnings

- The tester is not a Tester for the Absence of Voltage (TAV). Use a suitable instrument for this purpose.
- Do not immerse the unit or work in the rain.
- Inspect the unit before use. Do not use if damaged.
- If the “400V!” pictogram is displayed, check the installation.
- ASS operations must be carried out by the manufacturer.
- The addition of measurement current (<math><15\text{ mA}</math>) from the tester with fault current from computer or electronic equipment already plug can lead to the drop-out of the 30 mA circuit breakers.



FIG.1



FIG.2



FIG.3



FIG.4

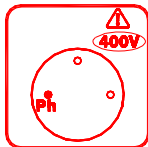

FIG.5



v081101